



Enriching Lives

FORGED STEEL GATE / GLOBE / CHECK VALVE

AS PER : BSEN ISO: 15761 / BSEN: 12266 - 1 / BS 5352



KIRLOSKAR BROTHERS LIMITED

FORGED STEEL GATE / GLOBE / CHECK VALVE

Widely accepted by National Thermal Power Corporation, Nuclear Power Corporation and Industrial users, Refineries. Designed as per latest editions of BSEN / API specifications.

Applications :

- Refineries
- Petrochemical Complexes
- Fertilizer Plants
- Thermal power station
- Process Industries

Technical Specification

Design and Manufacturing Standard	BSEN ISO: 15761 / ANSI B16.34/ API -602/ BS-5352
Testing Standard	BSEN: 12266 - 1 / API -598 / BS-5146
Size Range	8 mm to 50 mm
Face to Face dimensions	As per manufactures Std.
Socket Weld End	ANSI B: 16.11
Screwed End (BSP / BSPT)	BS: 21 / IS: 554
Screwed End (NPT)	ANSI B 2.1
Butt Weld Ends	ANSI B 16.25

Note: *For Higher Pressure Rating contact Design Office.

Material of Construction :

Body #	Forged Carbon Steel ASTM A 105	Gland flange \$	Forged Carbon Steel ASTM A 105
Gate ▣	13% Cr. Steel ASTM A 217 Gr. CA 15	Yoke Bush §	AISI 416 / Non Ferrous
Stem \$	ASTM A 276 type 410	Handwheel \$	Cast Steel / Forged Steel
Stem Nut ▣	AISI 416 / Non Ferrous	Piston %	ASTM A 276 type 410
Body Seat Ring #	ASTM A 276 type 410	Cover %	Forged Carbon Steel ASTM A 105
Disc §	30% Cr. Steel ASTM A 217 Gr. CA 15	Gland Packing \$	Braided Asbestos with metal corrosion inhibitor
Yoke Bonnet \$	Forged Carbon Steel ASTM A 105	Gasket #	Spiral wound St. Steel AISI 304 Graphoil
Gland \$	ASTM A 276 type 410	Spring %	SS AISI-316
		Fasteners #	ASTM A 193 Gr. B7/ A 194 Gr.2H.

Note : * For special material of construction ,Contact Design Office.

Applicable for Gate/ Globe/ Check Valve.

\$ Applicable for Gate/ Globe Valve.

▣ Applicable for Gate Valve.

§ Applicable for Globe Valve.

% Applicable for Check Valve.

FORGED STEEL GATE VALVE

Special features :

- Manufactured to API 602 / BS. 5352 Tested to API- 598/ BS-5146
- Outside Screw and Yoke type bolted bonnet construction
- Body and bonnet made from high quality forgings
- Easy access to stuffing box
- Self-aligning gland and follower
- Accurately machined gate and seat rings with mirror finished seating surfaces to assure leak tightness
- Wedge accurately guided throughout its travel in machined guideways in body
- Rolled in body seat rings of renewable type
- Back seating surfaces provided integral to bonnet

General Outline Drawing :

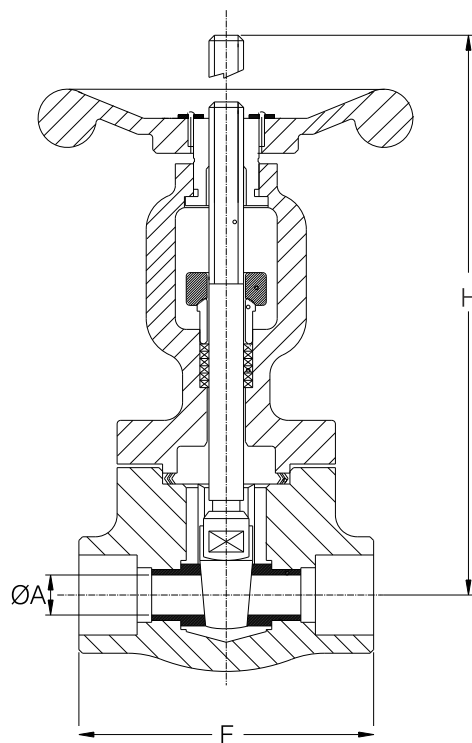

General Outline Dimensions :

Size	Reduce Bore		Full Bore		H (Open)
	A	F	A	F	
8	8	81	9	81	150
10	8	81	9	81	150
15	11	81	12	85	150
20	12	85	17	100	164
25	18.5	100	22	125	196
32	20	125	28	125	249
40	30	125	35	140	249
50	38	140	44	-	287

Note: All Dimensions are in 'mm' otherwise stated.

FORGED STEEL GLOBE VALVE

Special features :

- Manufactured to BS-5352. Tested to BS- 5146
- Outside screw and yoke type bolted bonnet construction
- Body and bonnet made from high quality forgings
- Taper Plug type disc and shoulder seated screwed renewable seat ring with perfect matching of mating parts to assure leak tightness
- Easy access to stuffing box
- Self-aligning gland and follower
- Streamline flow passages to minimize pressure losses and erosion
- Back seating surfaces provided integral to bonnet
- Horizontal type

General Outline Drawing :

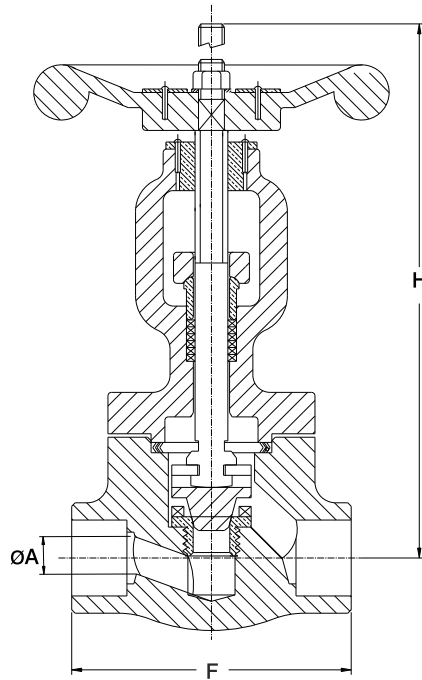

General Outline Dimensions :

Size	Reduce Bore		Full Bore		H (open)
	A	F	A	F	
8	8	81	9	81	155
10	8	81	9	81	155
15	11	81	12	85	155
20	12	85	17	100	164
25	18.5	100	22	125	196
32	20	125	28	125	249
40	30	125	35	140	249
50	38	140	44	-	287

Note: * All Dimensions are in 'mm' otherwise stated.

FORGED STEEL CHECK VALVE

Special features :

- Manufactured as per BSEN ISO: 15761 and tested as per BSEN: 12266 - 1
- Uniquely designed piston lift check valve incorporating self cushioning effect
- Taper plug type disc and shoulder seated screwed renewable seat ring for positive seating and drop tight seating
- Guided Piston assuming accurate Return to seat ring to achieve leaktightness
- Streamlined flow passages to minimize pressure losses and erosion
- Reduced bore or Full bore

General Outline Drawing :

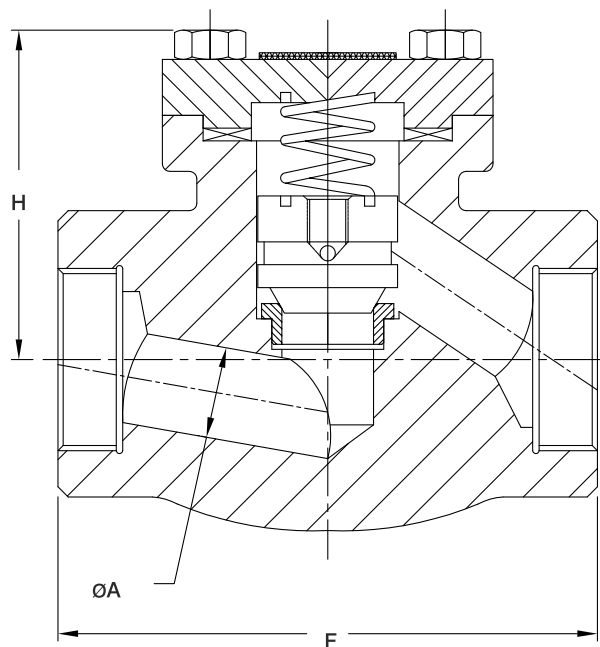

General Outline Dimensions :

Size	Reduce Bore		Full Bore		H
	A	F	A	F	
8	10	81	9	81	58
10	10	81	9	81	58
15	10	81	12	85	58
20	12.8	85	17	100	72
25	18	100	22	125	79
32	25	125	28	125	110
40	30	125	35	140	110
50	38	140	44	-	122

Note: * All Dimensions are in 'mm' otherwise stated.

End Connection :

- Socket Weld End
- Butt Weld Ends
- Screwed End (BSP / NPT)

Hydrostatic test Pressures Kg/Cm2:

Pressure Rating	Hydrostatic test Pressures Kg/Cm2:	
	Body	Seat
Class- 800	207	152

OUR GLOBAL PRESENCE



ABOUT KBL

Kirloskar Brothers Limited (KBL) is a world class pump manufacturing company with expertise in engineering and manufacture of systems for fluid management. Established in 1888 and incorporated in 1920, KBL is the flagship company of the \$ 2.1 billion Kirloskar Group. As the market leader in fluid management, KBL provides complete fluid management solutions for large infrastructure projects in the areas of water supply, power plants, irrigation, oil & gas and marine & defence. We engineer and manufacture industrial, agriculture & domestic pumps, valves and hydro turbines.

In 2003 KBL acquired SPP Pumps, United Kingdom and established SPP Inc., Atlanta, USA, as a wholly owned subsidiary of SPP, UK and expanded its international presence. In 2007, Kirloskar Brothers International B.V., The Netherlands and Kirloskar Brothers (Thailand) Ltd, a wholly owned subsidiary in Thailand were incorporated. In 2008, KBL incorporated Kirloskar Brothers Europe BV (Kirloskar Pompen BV since June 2014), a joint venture between Kirloskar Brothers International BV and Industrial Pump Group, The Netherlands. In 2010 KBL further consolidated its global position by acquiring Braybar Pumps, South Africa. SPP MENA was established in Egypt in 2012. KBL has a joint venture company with Ebara Corporation, Japan since 1988 for the manufacture of API 610 standard pumps. Kirloskar Corrocoat Private Limited is joint venture cooperation with Corrocoat Ltd., UK since 2006. KBL acquired The Kolhapur Steel Limited in 2007 and Hematic Motors in 2010. In 2014, KBL acquired SyncroFlo. Inc, the largest independent fabricator of commercial and municipal domestic water.

KBL has eight manufacturing facilities in India at Kirloskarvadi, Dewas, Kondhapuri, Shirval, Sanand, Kaniyur, Kolhapur and Karad. In addition, KBL has seven manufacturing and packaging facilities in Egypt, South Africa, Thailand, The Netherlands, United Arab Emirates, United Kingdom and United States of America. KBL has 12,700 channel partners in India and 80 overseas and is supported by best in class network of Authorised Centres and Authorised Refurbishment Centres across the country.

All plants of KBL are ISO 9001, ISO 14001 and OHSAS 18001 standards certified. They apply Total Quality Management tools using European Foundation for Quality Management (EFQM) model. The Kirloskarvadi plant of KBL is a state of art integrated manufacturing facility having one of Asia's largest hydraulic research centre with testing facility up to 5000 kW and 50,000 m³/hour.

KBL is the only pump manufacturing company in India and ninth in the world to be accredited with the N and NPT certification by American Society of Mechanical Engineers (ASME).



Scan this code with your smart phone to know more about KBL

As we are constantly endeavouring to improve the performance of our products / equipment, we reserve the right to make alterations from time to time and as such our products / equipments may differ from that detailed in this publication. For latest information you may get in touch with our Regional Sales Offices.



Enriching Lives

KIRLOSKAR BROTHERS LIMITED

A Kirloskar Group Company

GLOBAL HEADQUARTERS :

"YAMUNA", Survey No. 98 (3 to 7), Baner,
Pune - 411045, INDIA
Tel.: +91-20 27214444 Fax : +91-20 27211117
email : kblin@kbl.co.in Website : www.kirloskarpumps.com

REGISTERED OFFICE :

Udyog Bhavan, Tilak Road,
Pune - 411002, INDIA
Tel.: +91-20 24440770 Fax: +91-20 24440156

WORKS :

Kondhapuri, Gat # 252/2 + 254/2, Tal. : Shirur,
District Pune - 412208, INDIA
Tel.: 02137-240022 / 240044

Our Group Companies



KIRLOSKAR BROTHERS LIMITED
FGGC-08-2014-00

Pumps | Valves | Hydro Turbines | Turnkey Projects

Water Resource Management | Irrigation | Power | Industry | Gas, Oil & Defence | Building & Construction | Distribution | Customer Service & Spares